

DUAL PLATE CHECK VALVE

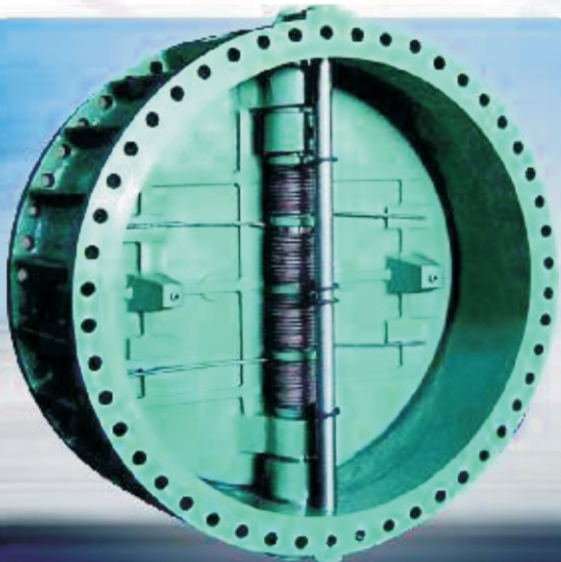

SWING TYPE NON RETURN VALVE

(SINGLE / MULTI-DOOR)

R&D Multiple's DPCV's combine the best design & constructional features with the top class workmanship making them unique for any kind of waterworks application. The clamped Resilient seal on the body is a feature which combines very high seal integrity & assurance against seal wash-off.

Independent spring action for each plate ensures that spring twist is half compared to the conventional designs. This greatly enhances the life of the springs.

Considering features as above & many others, **R&D Multiples's DPCV's** will give you the best the areas of features, workmanship, initial & running costs. This is the best choice.

The Swing Type NRV's have been commonly used over the years. Simplicity is their biggest advantage. **R&D Multiple's Swing Check Valve** primarily embody robustness & leak-tightness. Shorter Door Travel due to slant disc, eccentrically loaded door ensure quick reflux closing action to avoid the door slamming & consequent undesired effects. These are the NRV's that you can rely upon & relax.



WAFER TYPE DUAL PLATE CHECK VALVE

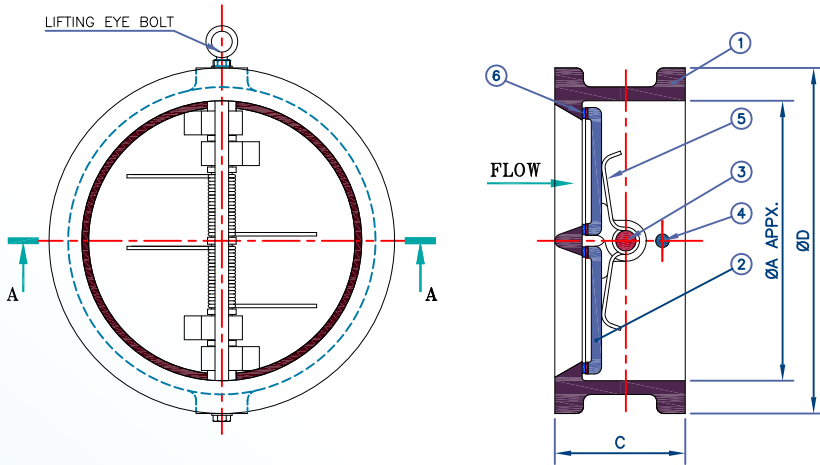

Size	C	ØD	APPX ØA	Size	C	ØD	APPX ØA
50	60	105	60	200	127	264	210
65	67	124	75	250	146	319	260
80	73	127	90	300	181	367	315
100	73	153	110	350	184	427	365
125	83	189	140	400	191	427	410
150	98	216	160	450	203	527	465

NO.	PART NAME	MATERIAL
1.	BODY	C.I. IS210 Gr. FG260
2.	DOOR (SEATING SURFACE)	C.S. ASTM A216 GR.WCB S.S. WELD OVERLAY
3.	HINGE PIN	S.S. AISI 410
4.	STOP PIN	S.S. AISI 410
5.	SPRING	S.S. AISI 304
6.	BODY SEAT	EPDM RUBBER
7.	END COVER	M.S. IS 2062 Gr.B
8.	EXTERNAL HARDWARE	C.S. IS 1367 Cl. 4.6/4

DOUBLE FLANGED DUAL PLATE CHECK VALVE

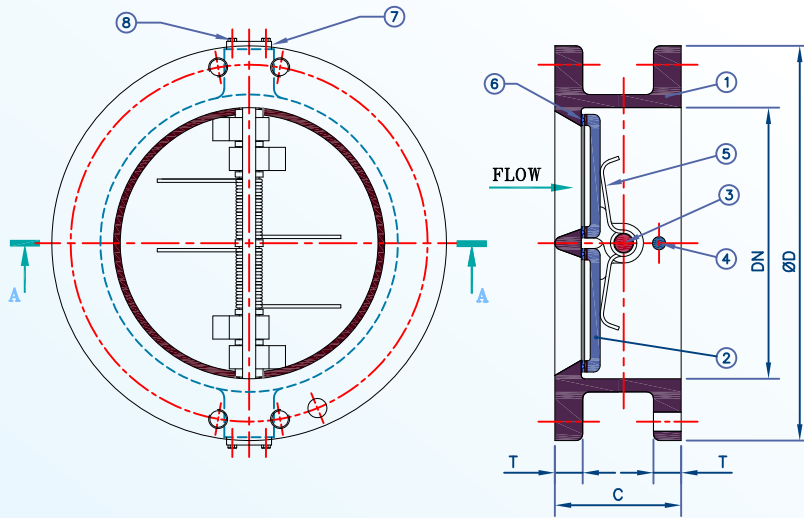

DN mm.	C	ØD	APPX ØA	DN mm.	C	ØD	APPX ØA
50	60	152	16	600	222	780	36
65	67	185	16	650	250	838	37
80	73	200	21	700	305	895	38.5
100	73	220	22	750	305	960	40
125	83	250	22.5	800	368	1015	41.5
150	98	285	23	900	368	1115	44
200	127	340	24.5	1000	432	1230	47
250	146	395	26	1100	432	1340	50
300	181	445	26.5	1200	524	1455	53
350	184	505	29	1300	525	1565	59
400	191	565	30	1400	525	1675	61
450	203	615	31.5	1500	565	1800	61
500	213	670	33	2000	760	2354	70

DOUBLE FLANGED DUAL PLATE CHECK VALVE : NS

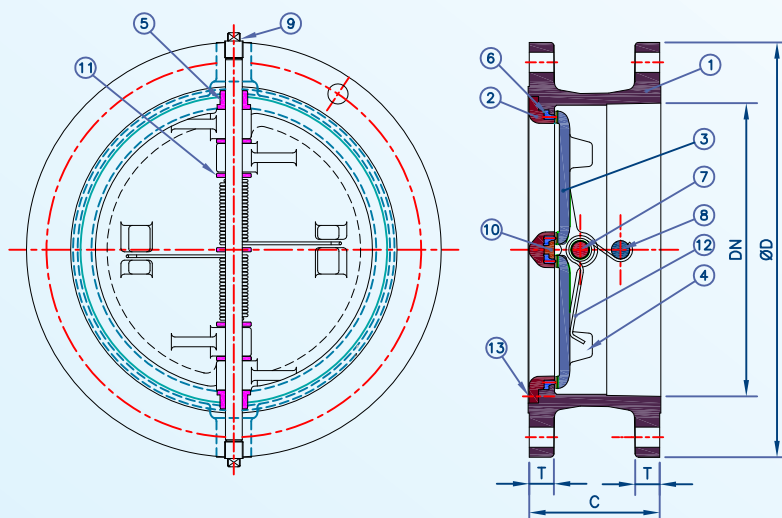

NO.	PART NAME	MATERIAL
1	VALVE BODY	C.I. IS 210 GR. FG 260
2	SEAT RETAINER	S.G. IRON IS 1865 GR. 500/7
3	DUAL PLATE - I	S.S. ASTM A351 CF8 M
4	DUAL PLATE - II	S.S. ASTM A351 CF8 M
5	BUSH	BRONZE IS 318 GR. LTB2
6	RUBBER SEAL	EPDM RUBBER
7	HINGE PIN	S.S. AISI 304
8	STOP PIN	S.S. AISI 304
9	RETAINER PLUG	STEEL
10	CLAMPING STRIP	MILD STEEL
11	SPACER	BRONZE IS 318 GR. LTB2
12	SPRING	S.S. AISI 304
13	INTERNAL HARDWARE	S.S. AISI 304

TILTING DISC CHECK VALVE

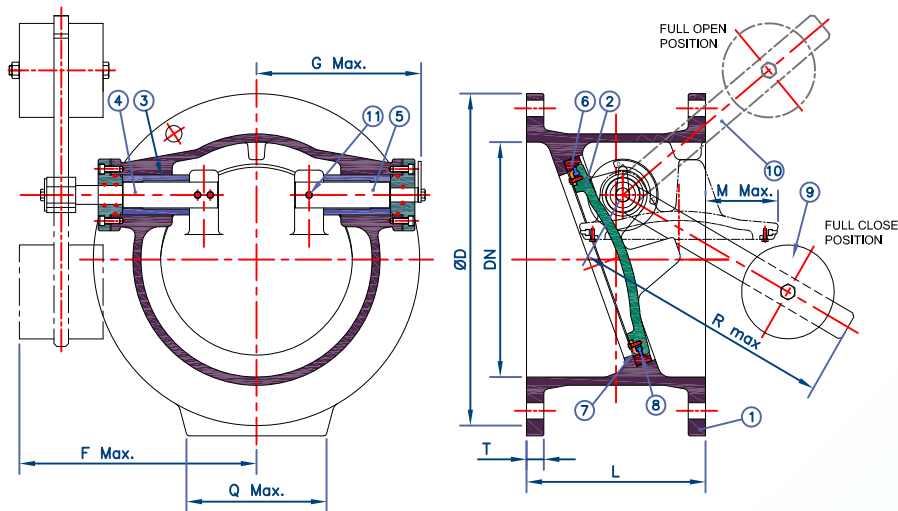

CONTACT OUR MKTG. DEPT. FOR SIZES FROM 1000mm TO 2000mm.

DN mm.	L	ØD	T	F Max.	G Max.	M Max.	R Max.	Q Max.
250	250	395	26	275	178	45	360	200
350	290	505	29	362.5	240	98	394	220
400	310	565	30	430	320	130	520	300
450	330	615	31.5	475	360	155	540	325
500	334	670	33	472.5	344	190	550	350
900	510	1115	44	760	527.5	412.5	950	550

NO.	PART NAME	MATERIAL
1	BODY	C I / S G I / C S / M S
2	DISC	C I / S G I / C S / M S
3	BEARING BUSH	C.I. / S G I
4	SHAFT DE	S S AISI 410
5	SHAFT DNDE	S S AISI 410
6	SEAT RING	S S AISI 304
7	DISC SEAL RING	S S AISI 304
8	COUNT SEAL RING	EPDM RUBBER
9	COUNTER WEIGHT	M S / C I
10	COUNTER WEIGHT LEVER	M S
11	SHEAR PIN	S S AISI 410

NON-RETURN VALUE (RESILIENT SEAT ON DISC)

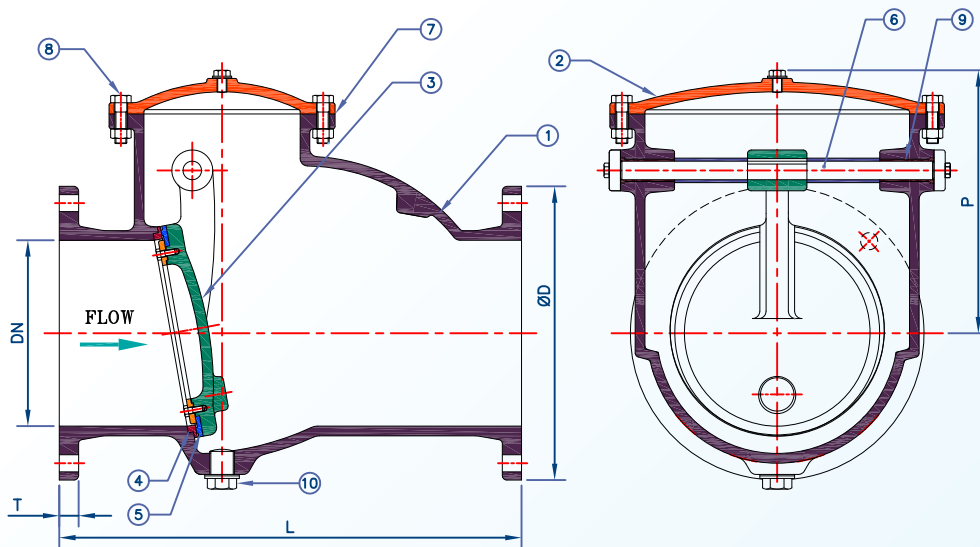

DN mm.	C	ØD	T	P
50	203	152	16	120
65	216	185	16	150
80	241	200	21	170
100	292	220	22	190
125	330	250	22.5	215
150	356	285	23	230
200	495	340	24.5	305
250	622	395	26	370
300	698	445	27.5	440
350	787	505	29	490
400	914	565	30	550
450	978	615	31.5	565
500	978	670	33	610
600	1295	780	36	710

METAL TO METAL SEAT (OPTIONAL)

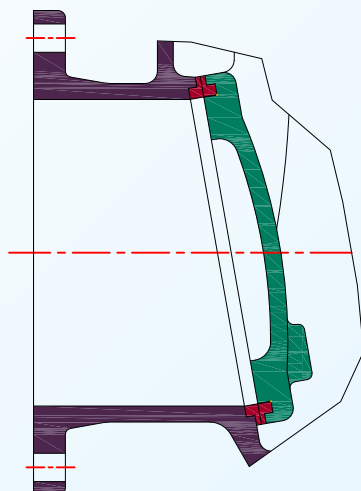

NO.	PART NAME	MATERIAL
1	VALVE BODY	C.I. IS 210 Gr.FG 260
2	COVER	C.I. IS 210 Gr.FG 260
3	DISC WITH HINGE	C.I. IS 210 Gr.FG 260
4	BODY RING	BR. IS 318 Gr. LTB2
5	DOOR FACE	EPDM RUBBER
6	HINGE PIN	S.S. AISI 410
7	GASKET	RUBBER IS 638 Gr. B
8	FASTENERS	C.S. IS 1367 CL. 4.6/4
9	BUSH	BR. IS 318 Gr. LTB2
10	DRAIN PLUG	STEEL

MULTI-DOOR SWING CHECK TYPE REFLUX VALVE

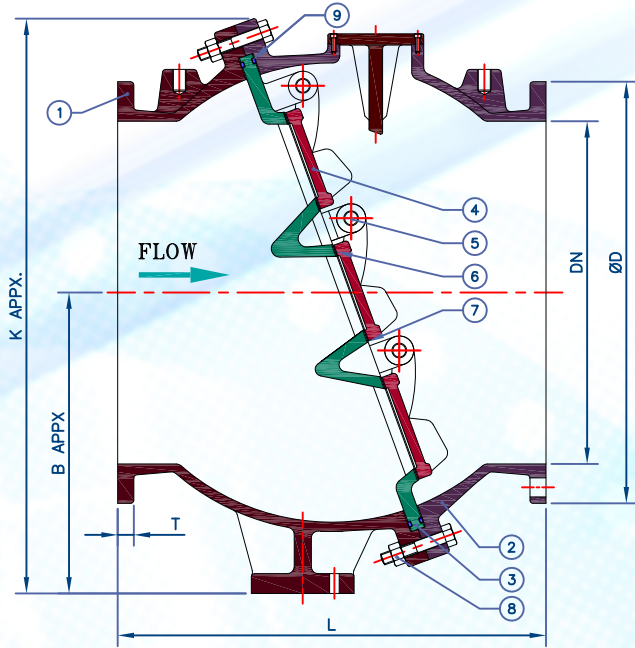

NO.	PART NAME	MATERIAL
1	INLET SHELL WITH FOOT	C.I. IS 210 Gr. FG 260
2	OUTLET SHELL	C.I. IS 210 Gr. FG 260
3	DIAPHRAGM	C.S. ASTM A 216 GR. WCB
4	DOORS	C.S. ASTM A 216 GR. WCB
5	HINGE PIN	S.S. AISI 410
6	DOOR FACE SEAL	EPDM RUBBER
7	DIAPHRAGM SEAT	S.S. AISI 304
8	FASTENERS	C.S. IS 1367 CL 4.6/4
9	'O' RINGS	NITRILE RUBBER

DN mm.	L	ØD	T	B	K
600	914	780	36	570	1080
700	1000	895	38.5	670	1255
750	1045	960	40	710	1355
800	1118	1015	41.5	780	1500
900	1250	1115	44	820	1565
1000	1250	1230	47	870	1665
1100	1396	1340	50	1000	1900
1200	1500	1455	53	1060	2030

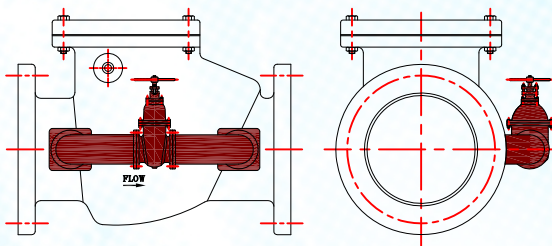

BY-PASS ARRGT. FOR NRV

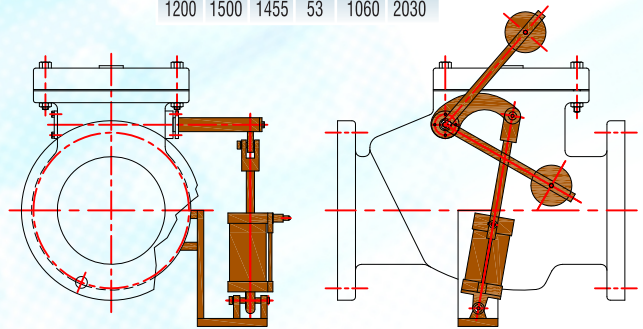

HYDRAULIC DASHPOT & C/W. ARRGT. FOR NRV

SALIENT FEATURES

- ♦ Single Door: 50mm to 600mm & Multi-Door : 600 to 1200mm sizes available.
- ♦ Pressure rating: PN 10, PN 16, PN 24. Others available on request.
- ♦ Inclined seats ensure shorter door travel leading to quick closing & opening.
- ♦ Material of construction : Shell : C.I., S.G.I., C.S. (WCB), D2. : Trim : Resilient, Bronze, S.S.
- ♦ Generally conforming to IS 5312 Standards.
- ♦ Large Hydrodynamic flow passages ensure minimum pressure drop across the valve.
- ♦ Drain plug, Air Release plug supplied. Mounting feet can be optionally provided for single door valves.
- ♦ Mounting Feet, Lifting Lugs & Inspection / stopper opening prove for multi - door valves.

SPECIAL FEATURES

- ♦ By-pass arrangement can be optionally supplied.
- ♦ Counter - weight arrgt. (externally adjustable) available for single door NRV's.
- ♦ Resilient Seats: Standard. Metal to Metal seats: Optional.
- ♦ Pneumatic / Hydraulic dashpot arrangement can be offered.

